

County Surveyor's Record, Tillamook County, Oregon

CHAINS

RESTORED CORNER FOR STATE OF OREGON--DEPARTMENT OF FORESTRY

Section corner common to Sections 22, 23, 26, and 27, T1N, R10W, W.M., Tillamook County, Oregon.

ORIGINAL by Samuel D. Snowden, May 15, 1857: Post (missing) from which a:

- 16" Hemlock bears S08°W 33 lks.; now rotted remains of uproot.
- 24" Spruce bears S48°~~W~~E 20 lks.; now rotted remains of uproot.
- 72" Spruce bears N40°W 54 lks.; now 76" stump, badly rotted, scribes visible.
- 32" Spruce bears N31°E 44 lks.; now remains of badly rotted root crown.

NOTE: Horizontal distances fit very well when measured from the approximate face of BT's.

RESTORATION by Milt Easton (not recorded).

- 24" Hemlock bears S51°E 4.0 ft.; now 38" stump, cut off below face, bears S22E 5.0 ft.

RESTORED

VAR 21½°E

Set 1½" X 36" galvanized iron pipe with 3" bronze cap marked "OREGON STATE BOARD OF FORESTRY T1N R10W S22 S23 S27 S26 1984 RS 1998", 34 inches in ground, and from which a:

- 54" Fir stump bears N23°E 35.1 ft. to face; scribed T1N R10W S23 BT
 - 22" Hemlock bears S79°E 120.5 ft. to face; scribed T1N R10W S26 BT
 - 14" Alder bears S09°E 69.5 ft. to bark scribes T1N R10W S26 BT
- Logging road bears South 59.0 ft.
No suitable tree available within limits in SW quadrant.

Set 6' metal fence post N45°W 1.0 ft. from corner pipe.
Oregon State Forestry Department metal location poster on 14" Alder BT.
Also poster on 54" Fir stump BT.

DATED February 9, 1984

RESTORED BY:

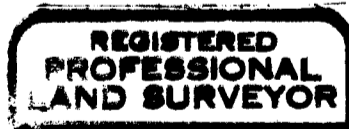

Anthony J. Klosterman

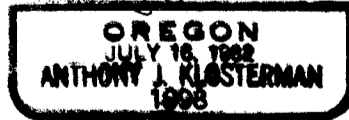

Present and witnessed by David B. Buchholz

